

6M X 3M PORTABLE BUILDING - STANDARD CONFIGURATION AVAILABLE IN 2.6M OR 2.8M HEIGHT AND WHITE OR BLACK FRAME

Doors and windows can be arranged to suit individual requirements.
Adaptations and modular configurations are available - please enquire.

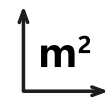

18 sqm (6m x 3m unit)

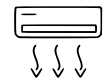

Option to add HVAC



2 x double-glazed windows (option for sliding or Euro-tilt)



Zinc-plated galvanised steel with a durable two-pack paint finish.

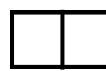

Internal walls are powder-coated (off-white gloss) galvanised sheet metal

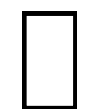

Commercial grade vinyl flooring



Insulated with fire retardant rock wall (72 mm walls, 100mm floor and ceiling)



4x10amp standard twin power outlets, external C-Form 32amp connection, switchboard



2x LED baton lights

A highly versatile and modular portable building system.

Standard configurations can be adapted to meet individual requirements; please ask for a quote or call our friendly team to discuss your project.

Highly-engineered building system for a wide range of spaces, including site and commercial offices, classrooms, clinics, storage, administration spaces, locker rooms, lunch rooms and more.

Inclusions in every new standard 6m x 3m building:

- 1x 6m x 3m portable building (18sqm)
- 2x Double-glazed Euro-tilt or sliding windows
- 1x Standard swing door (right-hand or left-hand)
- LED lighting
- 4x Power outlets
- Electrical WOF - 4 years
- Multi-part building warranty

Excluded and charged separately based on requirements: delivery, install time, adaptations, site or ground works, and joining kit if connecting buildings.

Optional adaptations: different flooring options, sliding doors, extra windows/doors, signage and branding and custom internal fit-out.

WALL PANELS:
 EXTERIOR CLADDING:
 PROFILED GALVANISED SHEET METAL - 0.5mm
 INTERIOR CLADDING:
 PROFILED GALVANISED SHEET METAL - 0.5mm
 INSULATION:
 69mm ROCK-WOOL (DENSITY 110 - 120KG/M)

DRAINAGE POINTS:
 4 X 50mm PIPE DRAINAGE TO DISCHARGE BELOW UNIT

PAINT SPECIFICATION:
 TOP AND BOTTOM FRAME:
 ELECTROGALVANISING: ZINC 10 MICRONS
 PRIMER COATING: ZINC RICH 20 MICRONS
 TOP COATING: POLYURETHANE TOP COAT 50 MICRONS
 TOTAL DRY FILM THICKNESS - 80 MICRONS

CORNER CASTING AND CORNER POST:
 SHOP PRIMER: ZINC RICH 10 MICRONS
 PRIMER COATING: ZINC RICH 20 MICRONS
 TOP COATING: POLYURETHANE TOP COAT 50 MICRONS
 TOTAL DRY FILM THICKNESS - 80 MICRONS

FRAME PAINT: BLACK OR WHITE OPTIONS @ BRIGHTNESS 70-80

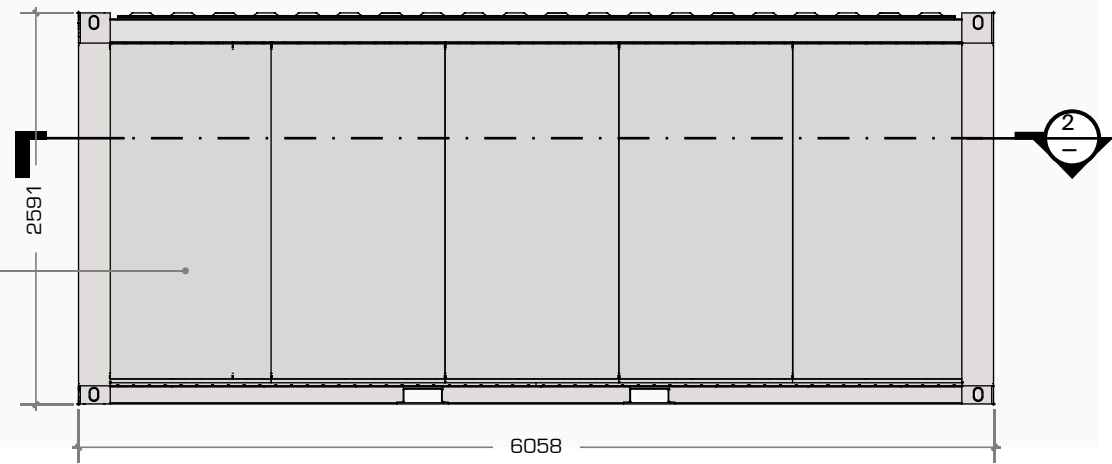

5 REAR ELEVATION
 1:50 at A3

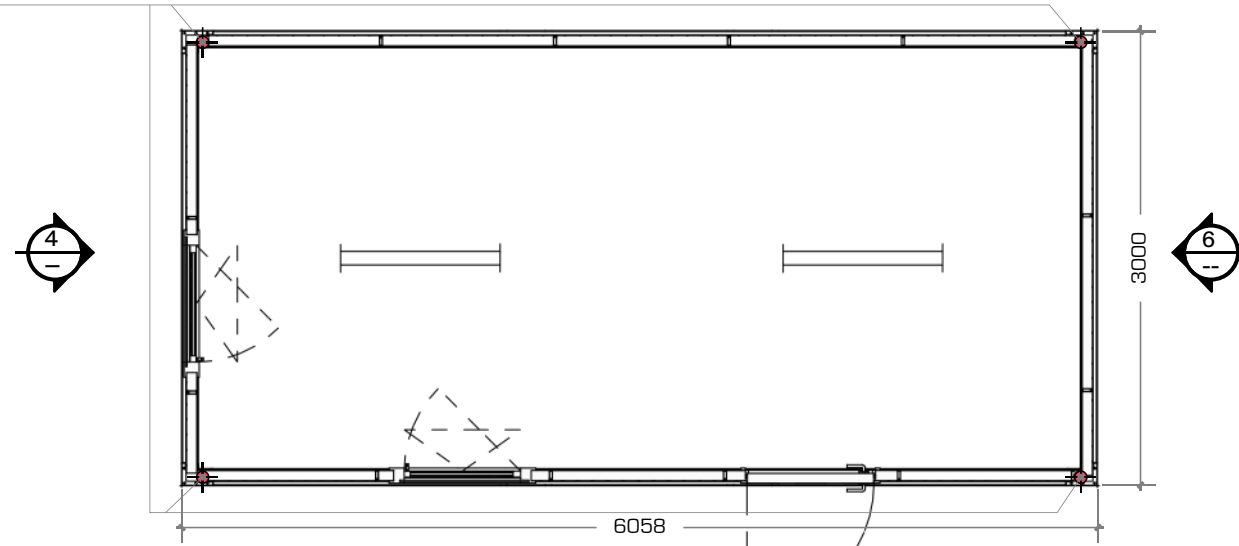

2 SECTION - PLAN VIEW
 1:50 at A3

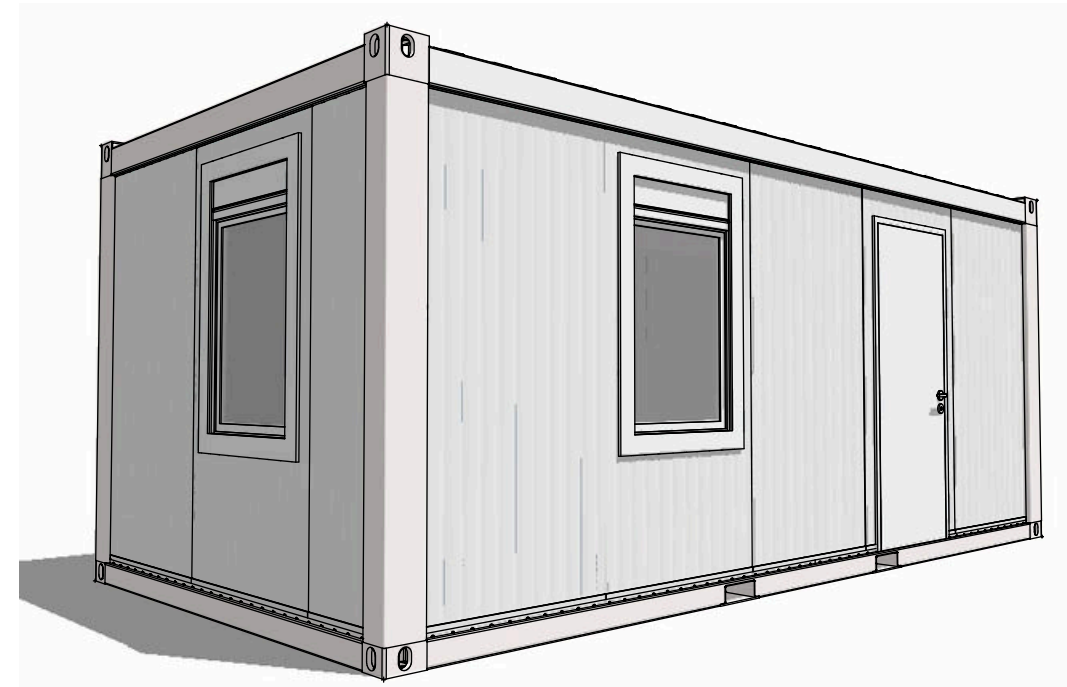

1 PERSPECTIVE VIEW
 Not to Scale

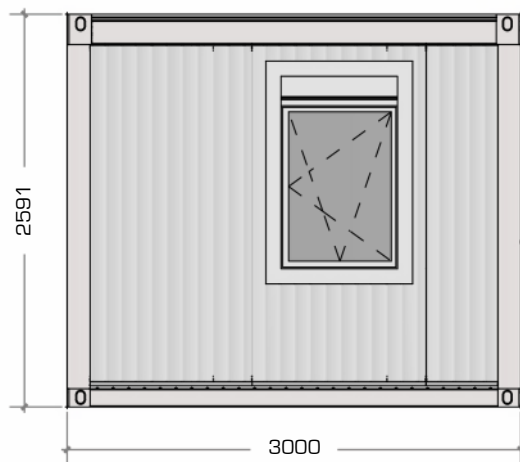

4 LHS ELEVATION
 1:50 at A3

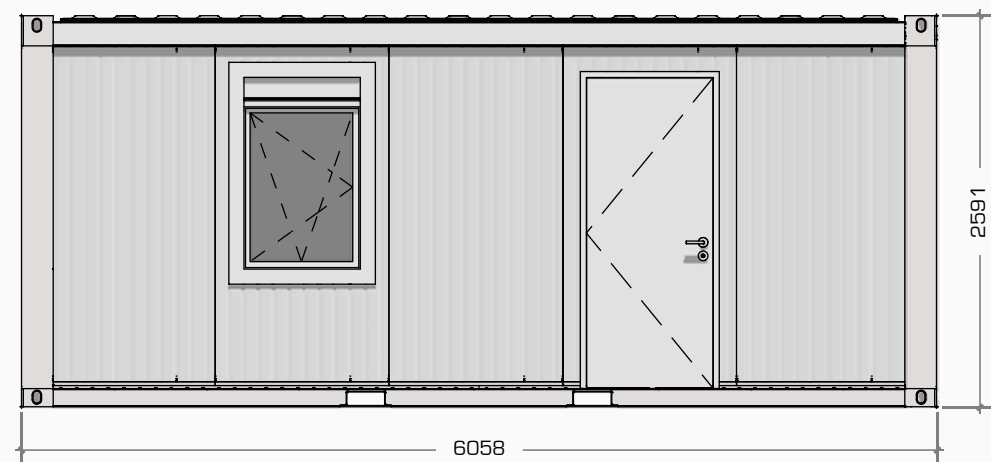

3 FRONT ELEVATION
 1:50 at A3

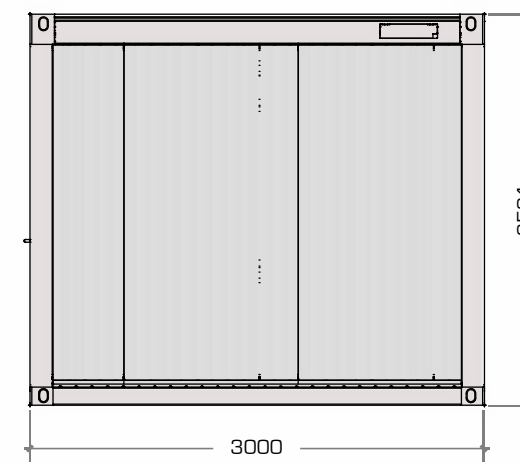

6 RHS ELEVATION
 1:50 at A3



Project:
 PACIFIC PORTABLE BUILDINGS
 6X3 WHITE FRAME

Dwg Title:
 GENERAL ARRANGEMENT

Dwg No.: PPB63B_01

Revision:
 A For Information





Date:
 11/04/23

PACIFIC PORTABLE BUILDINGS
 42A Wilkinson Road, Ellerslie, ,
 Auckland, New Zealand
 Ph: +64 (09) 846 8650
 www.pacificportables.co.nz

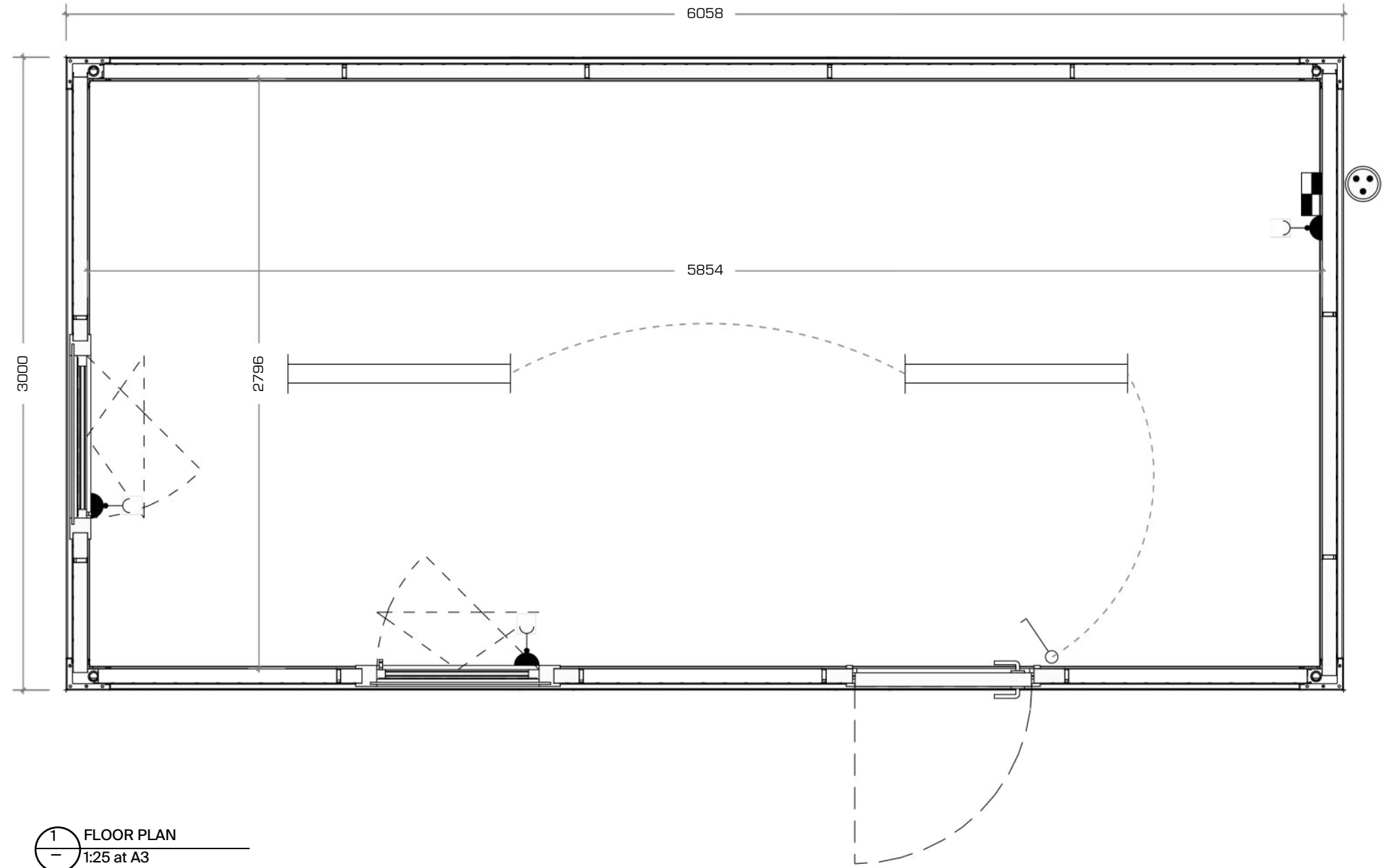
This drawing and the information it contains is the property of PACIFIC PORTABLE BUILDINGS and shall not be reproduced or transmitted without their express permission.

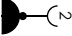
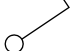
Scale: 1:50 at A3



-  DOUBLE POWER POINT
(300MM ABOVE FLOOR LEVEL
UNLESS OTHERWISE STATED)
-  LIGHT SWITCH
-  LED STRIP LIGHT
-  MAIN SWITCHBOARD
-  32A CEE 3P CONNECTION

1 FLOOR PLAN
- 1:25 at A3